

Only the wires from Control Panel to the Vent are to be Fire Proofed.

The wires from the Control Panel to the Fireman's Switches are Signal Wires.

General Notes:

1. Do not scale this drawing.
2. Conforming to Scottish Building Regulations 2009. Section E2.14
3. Tested and Complies to BS EN 12101-2:2003 at Exova Warringtonfire.

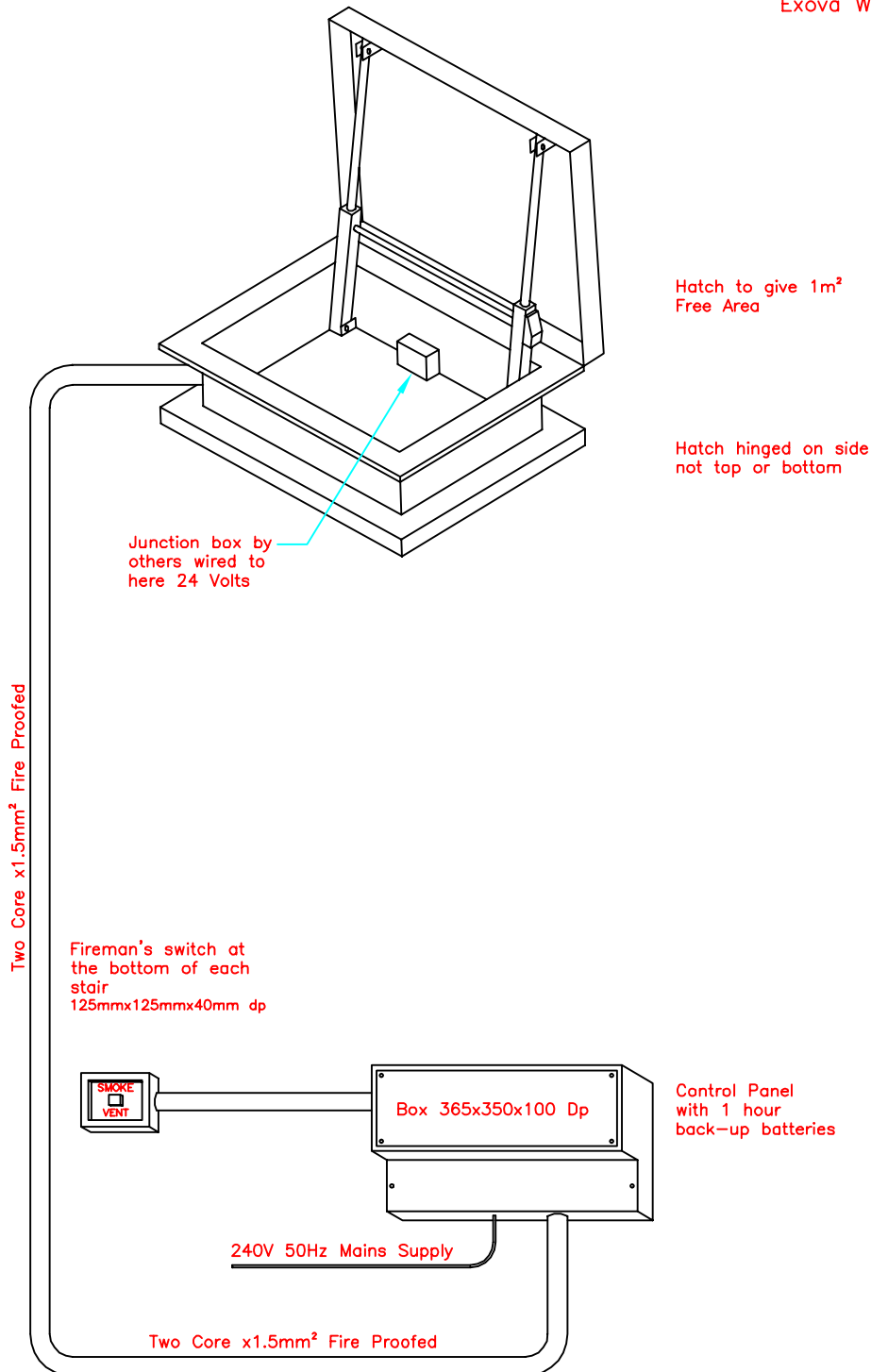

LAREINE ENGINEERING LTD.

UNIT 1, ARMADALE INDUSTRIAL ESTATE.
 ARMADALE EH48-2JY WEST LOTHIAN.
 Tel 01501 731 600 Fax 01501 733 828

Title/Name

Smoke Hatch with Linear Actuators
 Up to Two Stories

Drawn	Date	Scale	Drawing number	Rev
AWA	-	Not To Scale	STD - 024	-