

Plan on Rooflight
Scale 1:20

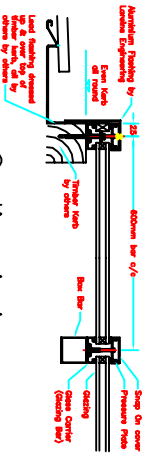

Section A-A
Scale 1:5

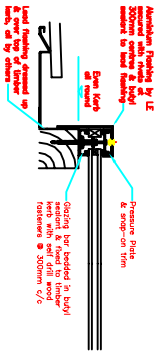

Detail 1
Scale 1:5

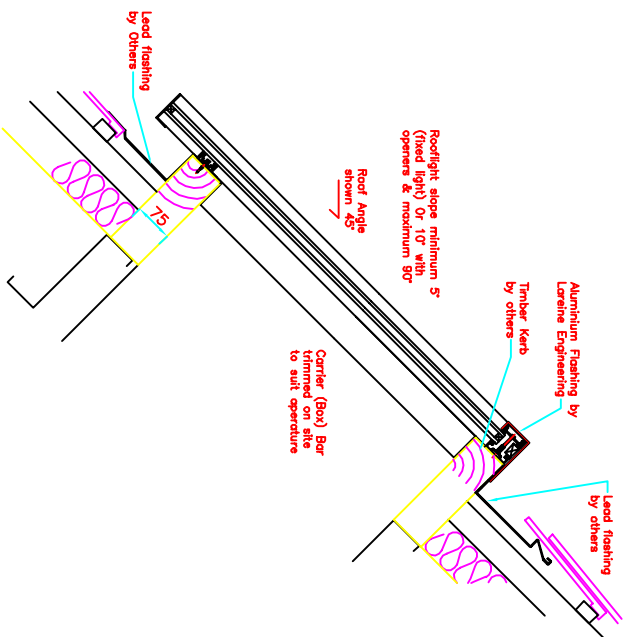

Section B-B
Scale 1:5

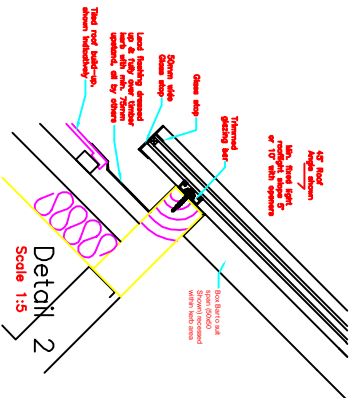

Detail 2
Scale 1:5

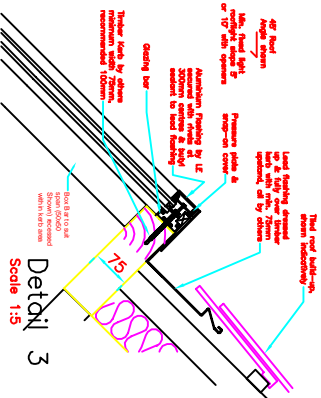

Detail 3
Scale 1:5

General Notes:

1. Do not scale this drawing.
2. All Lareine Engineering Ltd drawings are to be read in conjunction with the relevant Lareine Engineering Ltd Specification and all relevant Architects and Service Engineer's drawings and Specifications.
3. All levels are in metres above ordnance datum. All dimensions are in mm's unless noted otherwise.
4. Do not scale any Lareine Engineering Ltd drawings. If in doubt, contact the relevant Engineering Dept. Any dimensions in red are deemed to be referred to the Designer before work is put to hand.

Specification: (Typical)

Glazing Details
 Sealed double glazed units comprising:
 6.0mm Clear toughened outer;
 16mm Air gap argon filled;
 6.4mm Clear Low 'E' Laminate inner;

Frame
 Polyester powder coated,
 Standard RAL colour – As Required.

<p>LAREINE ENGINEERING LTD. UNIT 4, ANFIELD INDUSTRIAL ESTATE, 1000, WILSON ROAD, WILSON, LEICESTER, LE12 9JG. TEL: 01533 410000 FAX: 01533 410001</p>		<p>Rooflight Details for Monopitch Roof</p>	
Rev	Revision made	Date	By
A	Drawing complete	28/07/2016	ENW
Drawn	Checked	Drawn	Checked
AWA	As Shown	STD - 026	A