

Wiring Spec to be confirmed by clients electrical contractor

General Notes:

1. Do not scale this drawing.
2. Conforming to Scottish Building Regulations 2009. Section E2.14
3. Tested and Complies to BS EN 12101-2:2003 at Exova Warringtonfire.

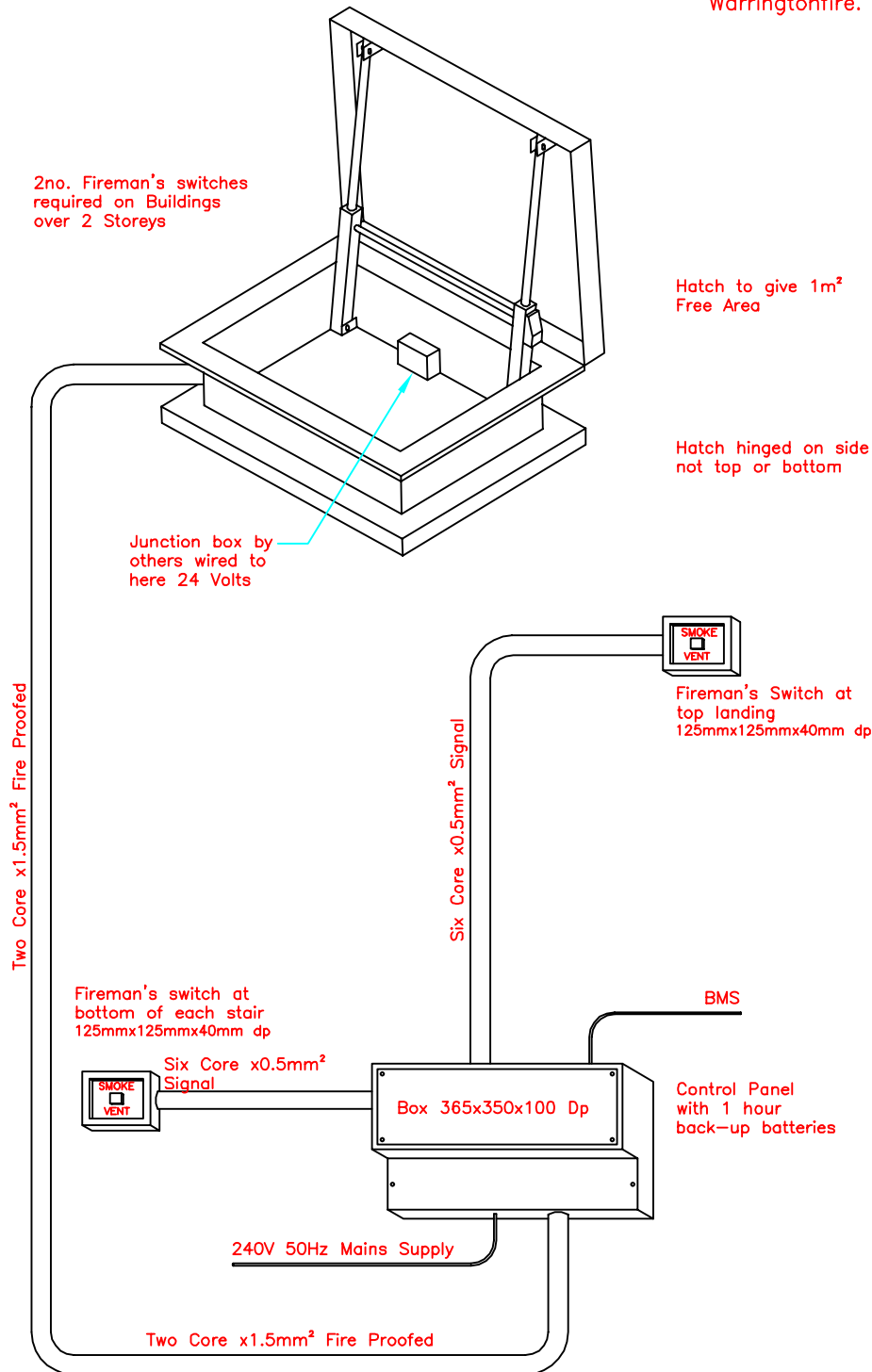

**LAREINE ENGINEERING LTD.**

UNIT 1, ARMADALE INDUSTRIAL ESTATE.  
ARMADALE EH48-2JY WEST LOTHIAN.  
Tel 01501 731 600 Fax 01501 733 828

Title/Name  
Smoke Hatch with Linear Actuators  
Over Two Stories

Drawn	Date	Scale	Drawing number	Rev
AWA	-	Not To Scale	STD - 022	-